

# PAVILION HILLTOP

Mont'Kiara  
Kuala Lumpur

## CONTACT US:

Lim

017- 885 4344

Lawrence

012- 321 9655

THE HIGH POINT OF MONTKIARA

PAVILION  
HILLTOP  
Mont'Kiara  
Kuala Lumpur

### PAVILION HILLTOP PROJECT DESCRIPTION

Selling Price From RM1,100psf

Build Up 1,200 - 1,800sf (3-4 Rooms)

Rental Price From: RM3.5psf

Fully Furnish With ID Design

### LOCATION MAP:

PLANNED AS A GLOBAL VILLAGE WITH ITS STRATEGIC LOCATION, Mont'Kiara has a wide range of facilities and services, including

- International Schools
- Golf Course
- Equestrian Club
- Financial Institutions
- Shopping Malls
- F&B Outlets

MONT'KIARA IS WELL CONNECTED AND IS EASILY ACCESSIBLE BY

- SPRINT Highway
- DUKE Highway
- Penchala Link
- North-South Highway

Just 25 minutes distance drive to KLCC





Prestigiously acclaimed and widely recognised as **GLOBAL HIGH-RISE TOWNSHIP** by the expatriate community

One of the **FAVOURITE LOCATIONS FOR PROPERTY INVESTMENT** as well as for **OWNER OCCUPATION**

**PAVILION HILLTOP**  
Mont'Kiara  
Kuala Lumpur

**Type A**

Built-up area 1,200 sq. ft. / 111.48 sq. m.

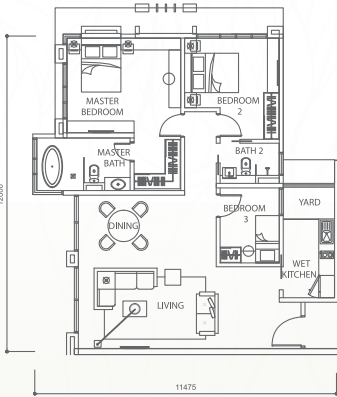

**Type B**

Built-up area 1,496 sq. ft. / 138.98 sq. m.

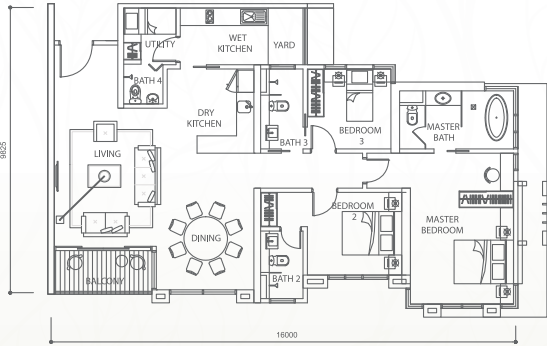
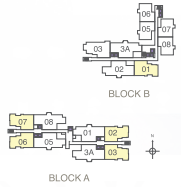

**Type C**

Built-up area 1,668 sq. ft. / 154.95 sq. m.

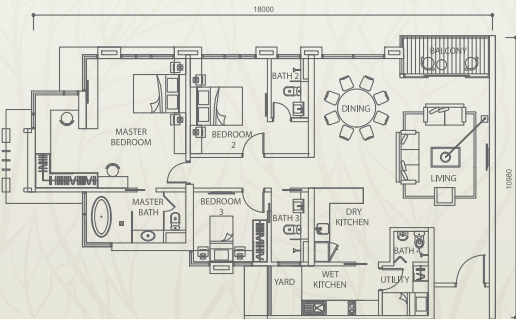
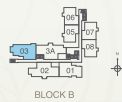

**Type D**

Built-up area 1,830 sq. ft. / 170 sq. m.

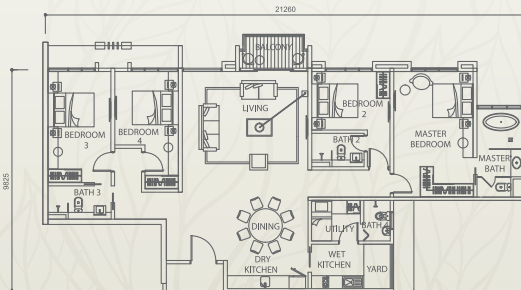
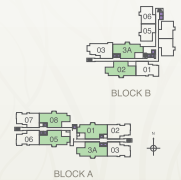

\*For Illustration Purpose Only

